

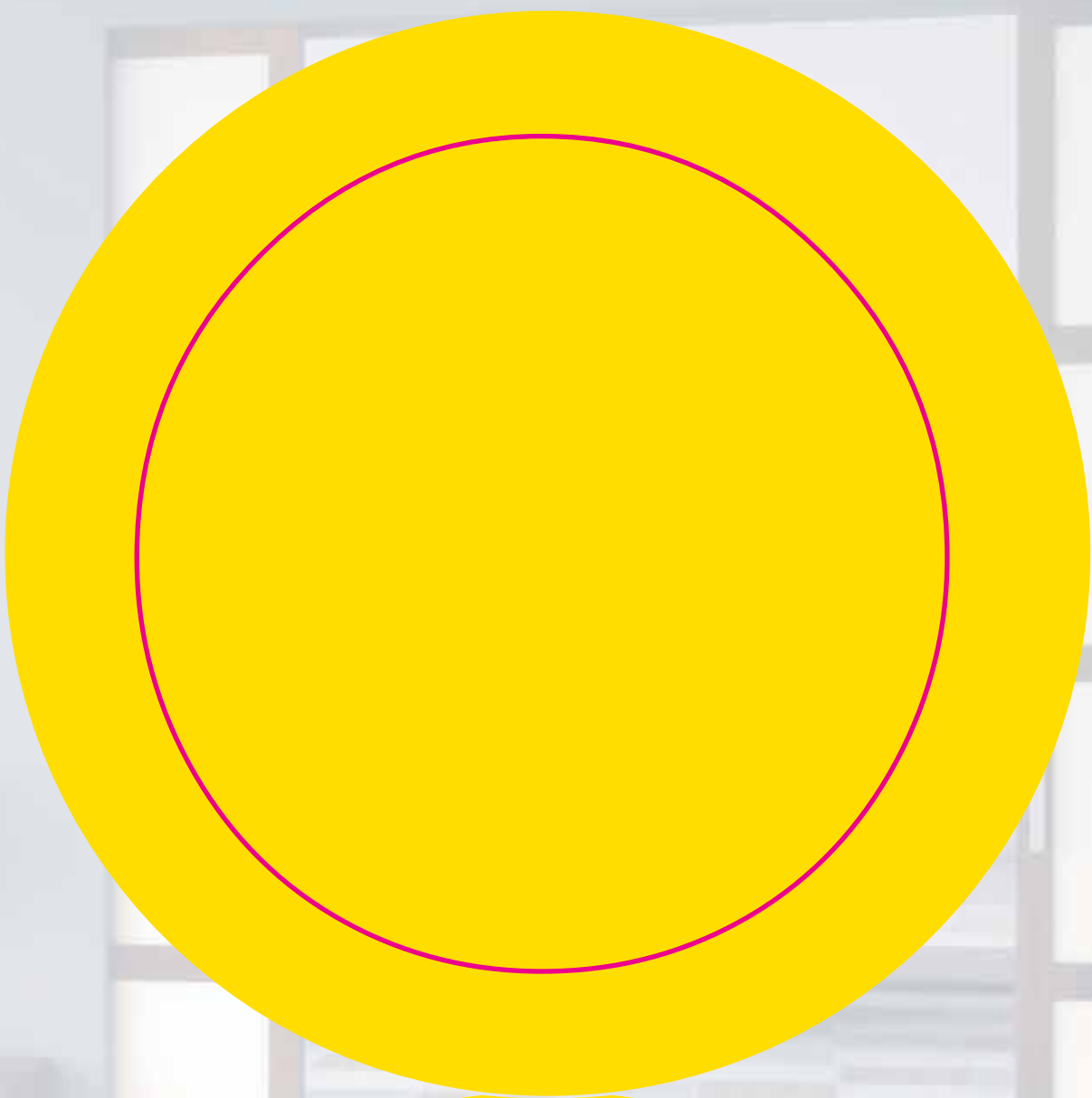

briouk.com



Brio[®] where ideas unfold

Brio[®] Residential
Pack Set Range

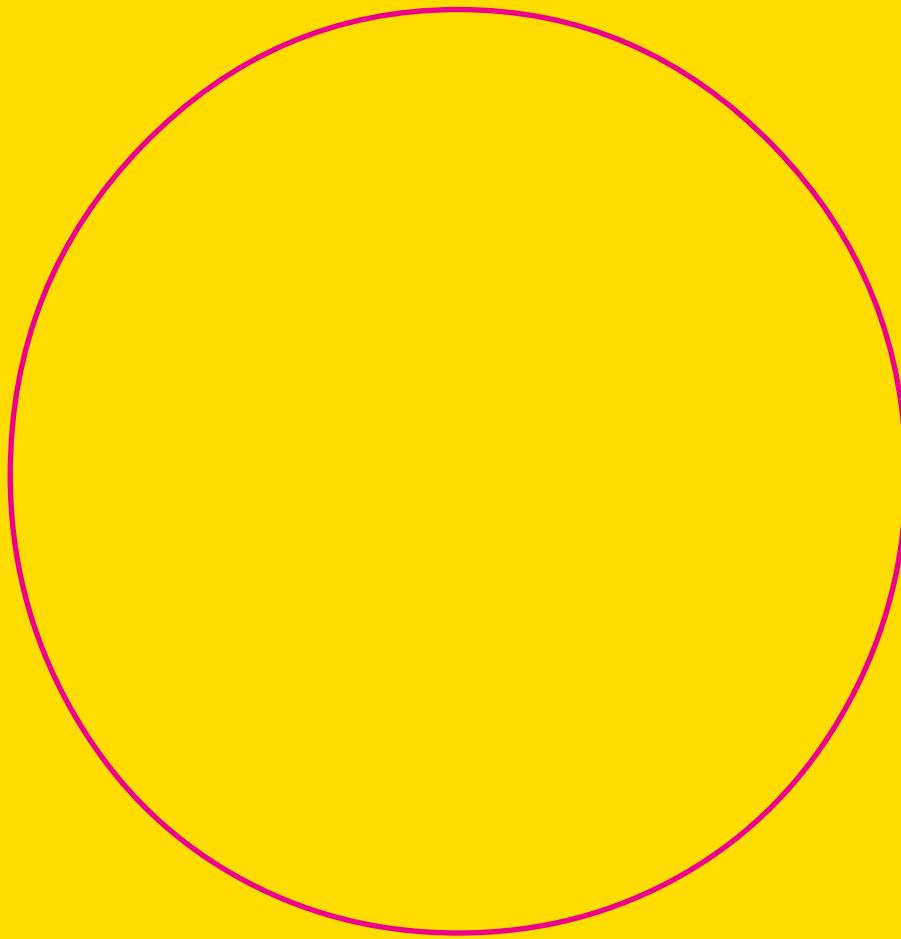

About us

Brio® where ideas unfold

Watch your adventurous architectural ideas unfold into exciting reality with the Brio range of sliding and folding door hardware.

Brio is passionate about shaping the spaces in which people live, work and play. With subsidiaries in the UK, USA and New Zealand – Brio is recognised around the world as a leading design and manufacturing

company. Brio's R&D department brings a strong design element to the business, developing and testing ground breaking concepts that continue to lead the industry. So it's no surprise our name Brio translates to Energy, Spirit and Vitality – the core values that drive us to always discover new solutions for our customers.



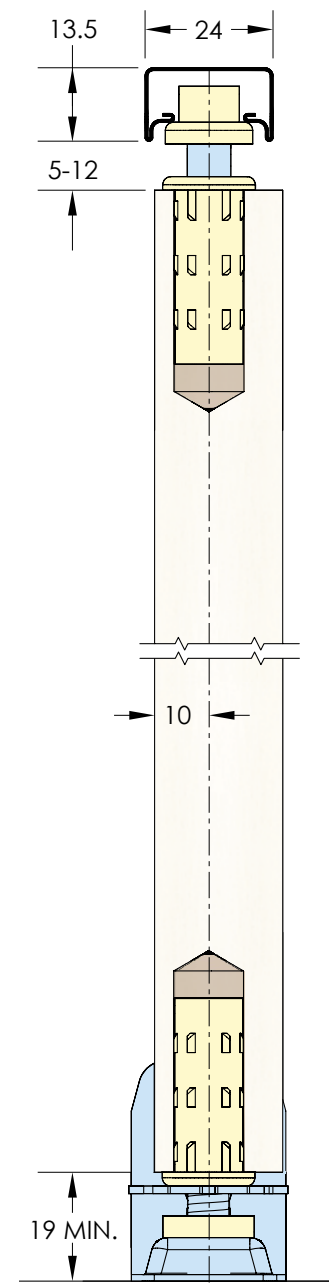

Bifold 16

Max Panel Weight	Max Panel Width	Max Panel Height	Min Panel Thickness	Height Adjustment	Horizontal Adjustment
16kg	620mm	2400mm	19mm	± 3.5mm	± 4mm

Application

Bifold 16 is a simple to install, folding door hardware system for panels weighing less than 16kg. Neither top hung or bottom rolling; Bifold 16 supports the panels at the pivot base and incorporates spring loaded guides at the head. Bifold 16 is designed to be used without a bottom channel which makes it ideal for cupboards, pantries, laundry rooms and room dividers. The top channel is only 13.5mm high which maximises the opening and is easy to conceal.

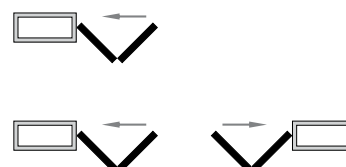

Kits Available

BF16-09/2

Opening Width: Up to 920mm, 2 Panels

BF16-12/2

Opening Width: Up to 1250mm, 2 Panels

BF16-18/4

Opening Width: Up to 1830mm, 4 Panels

BF16-25/4

Opening Width: Up to 2500mm, 4 Panels

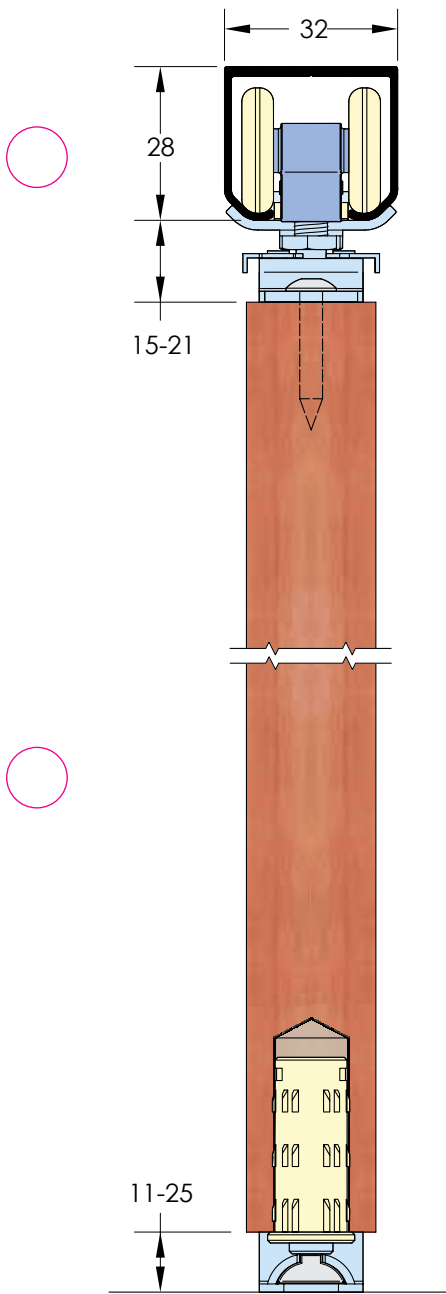

Multifold 30

Max Panel Weight 30kg	Max Panel Width 650mm	Max Panel Height 2400mm	Min Panel Thickness 19mm	Height Adjustment ± 3mm	Horizontal Adjustment ± 4mm
---------------------------------	---------------------------------	-----------------------------------	------------------------------------	-----------------------------------	---------------------------------------

Application

Multifold 30 is the latest from Brio in versatile interior folding door hardware systems. The axis on the pivot and hangers are within 25mm of the edge of the door, minimising the overhang of the panels, improving appearance and making it possible to fit trim to hide the gap between track and panel. The all new bearing hanger has a quick attach and release mechanism along with a single spanner height adjustment making installation easy.

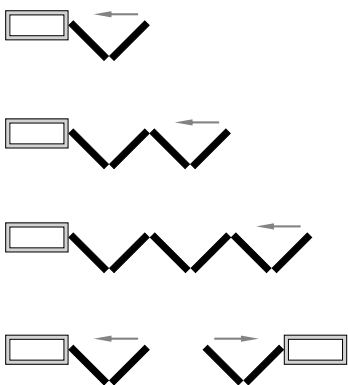

Kits Available

MF30-13/2
Opening Width: Up to 1300mm for 2 Panels

MF30-26/4
Opening Width: Up to 2600mm for 4 Panels folding to one side.

MF30-2PK
2 Panel Pack

MF30-4PK
4 Panel Pack

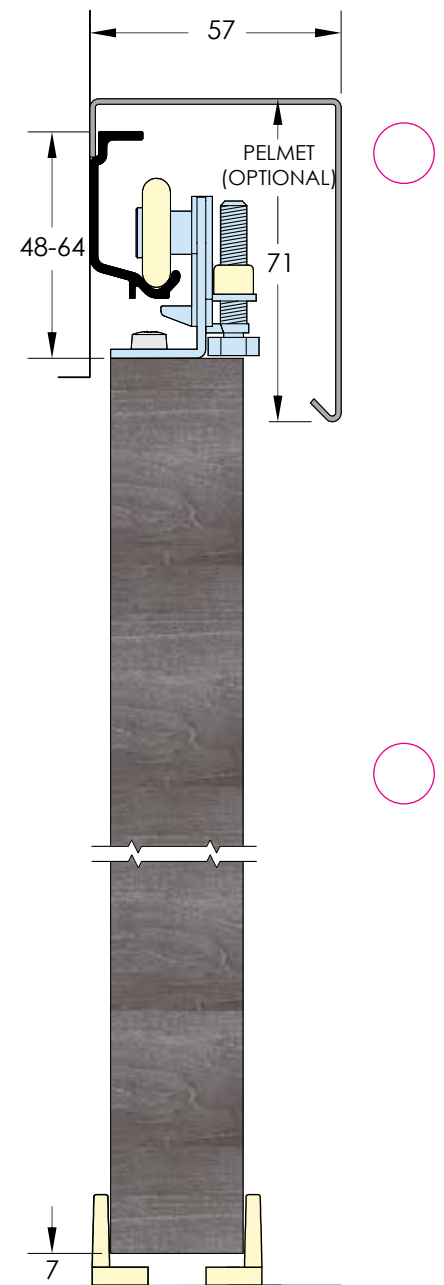

Sprintline 30

Max Panel Weight	Max Panel Width	Max Panel Height	Min Panel Thickness	Height Adjustment	Horizontal Adjustment
30kg	1500mm	2400mm	25mm	± 9.5mm	-

Application

Sprintline 30, new to the UK, is now even better. The track is made from extruded aluminium for a smooth, quiet motion. The height can accurately be adjusted whilst the hanger takes the full weight of the panel. The pelmet is also made from extruded aluminium and is available in powder coat white.

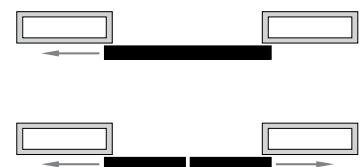

Kits Available

- SL30-16/1**
Track Length: 1600mm, Single Panel
- SL30-24/1**
Track Length: 2400mm, Single Panel

Pelmet with End Caps

- 170-18**
Pelmet Length: 1800mm
- 170-30**
Pelmet Length: 3050mm

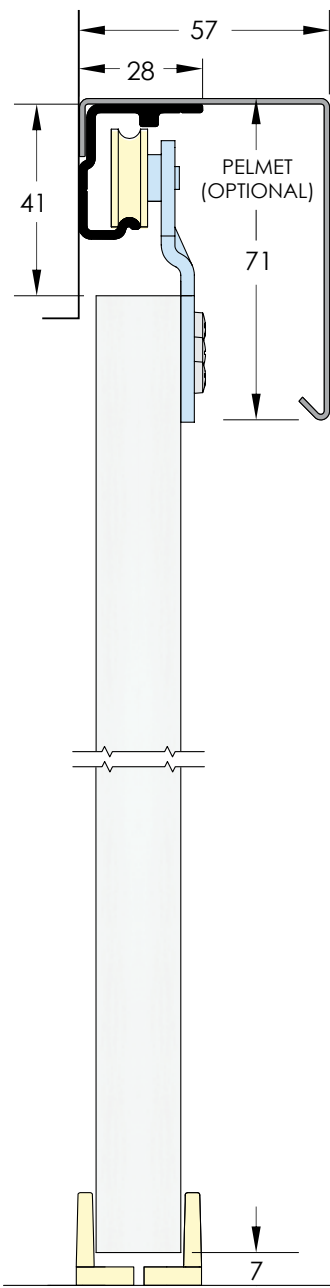

Wardrobe Single 50

Max Panel Weight

50kg

Max Panel Width

900mm

Max Panel Height

2400mm

Min Panel Thickness

16mm

Height Adjustment

± 3mm

Horizontal Adjustment

-

Application

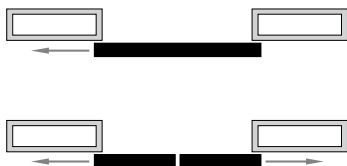

Wardrobe Single 50 is a durable heavy duty slide with an adjustable face fix hanger suitable for thin medium density fibre MDF board. The high speed precision sealed bearing runs on a soffit or face fix aluminium rail for a long lasting smooth action. Sealed bearings ensure extended life and the track can be dressed with the option of a white powder coat aluminium pelmet.

Kits Available

WS50-12/1

Track Length: 1200mm, Single Panel

WS50-15/1

Track Length: 1500mm, Single Panel

WS50-18/1

Track Length: 1800mm, Single Panel

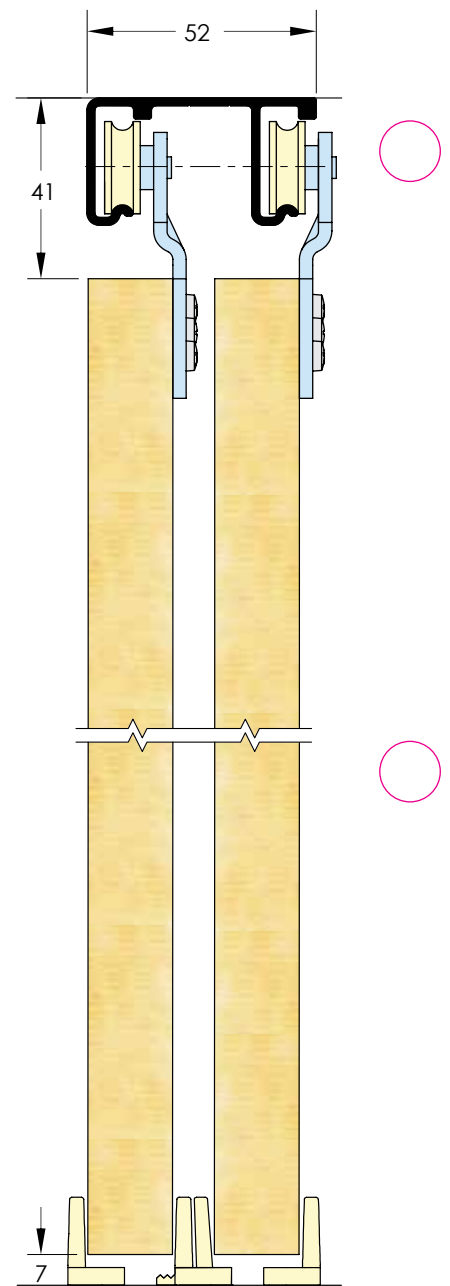

Wardrobe Double 50

Max Panel Weight	Max Panel Width	Max Panel Height	Min Panel Thickness	Height Adjustment	Horizontal Adjustment
50kg	900mm	2400mm	16mm	± 3mm	-

Application

Wardrobe Double 50, as the name implies, is designed specifically for wardrobes. It is a top hung system that can accommodate panels weighing 50kg each. The face fix hangers are adjustable and fitted on the blind side of the opening. Wardrobe Double 50 can be extended to three panels on three lines by adding Wardrobe Single 50 to run in parallel.

The expectation of wardrobes is they operate in silence. Brio is one of a few manufacturers that use precision bearings as standard to reduce noise and ensures the system remains that way.

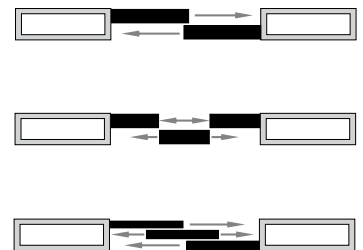

Kits Available

WD50-12/2

Opening Width: 1200mm, 2 Panels

WD50-15/2

Opening Width: 1500mm, 2 Panels

WD50-18/2

Opening Width: 1800mm, 2 Panels

WD50-24/3

Opening Width: 2400mm, 3 Panels

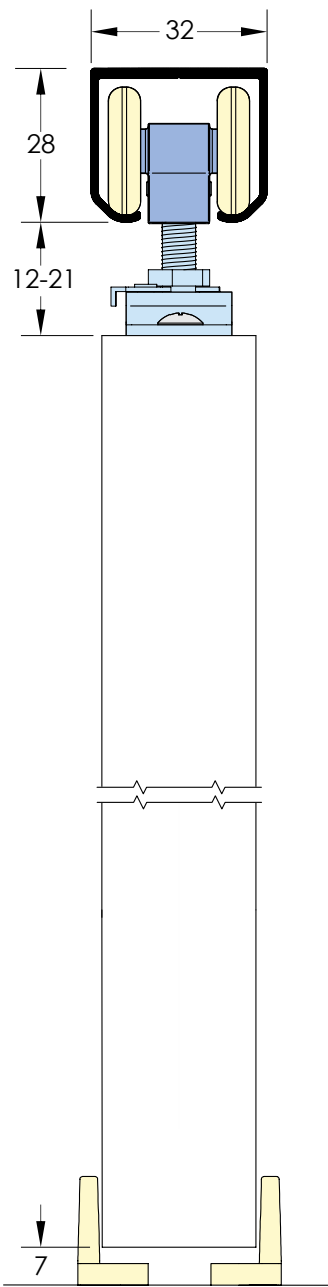

Single Run 60

Max Panel Weight

60kg

Max Panel Width

1525mm

Max Panel Height

2400mm

Min Panel Thickness

19mm

Height Adjustment

± 4.5mm

Horizontal Adjustment

—

Application

Single Run 60 is the most versatile of all slides, with a full 'C' section aluminium track and 4 wheels per hanger for long life, stability and high capacity.

Single Run 60 shares the same features as Multifold 30; quick snap connection with side feed to make the installation seamless and easy, this is particularly useful when used in cavity door applications. Easy Height adjustment with a single spanner supplied.



Kits Available

SR60-20/1

Track Length: 2000mm, Single Panel

SR60-30/1

Track Length: 3000mm, Single Panel

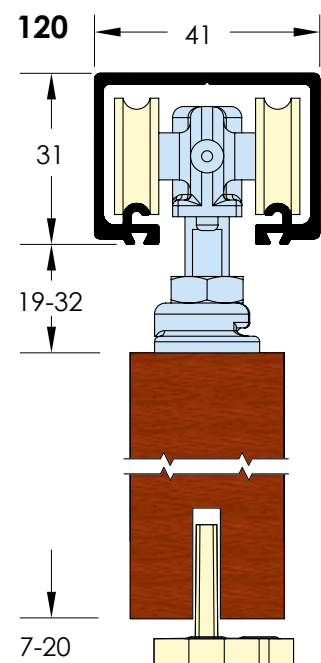
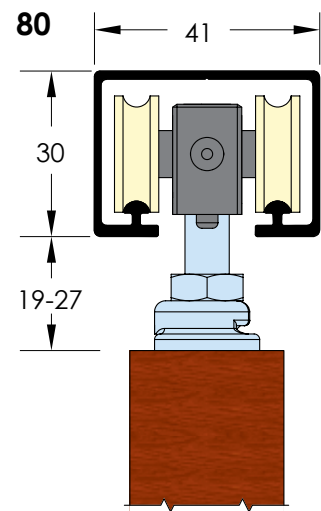

Single Run 80 and 120

Max Panel Weight	Max Panel Width	Max Panel Height	Min Panel Thickness	Height Adjustment	Horizontal Adjustment
80/120kg	2000mm	3000mm	28mm	± 4.0mm	-

Application

Single Run 80 and Single Run 120 bridge residential to light commercial, the doors at 80kg or 120kg are likely to be custom made and out of the ordinary. Single Run 80 uses a structural polymer hanger body running in an aluminium track that has no seal groove for that contemporary clean look. In comparison, the heavier duty Single Run 120 has a cast stainless steel body and cast mounting plate for extra support. The '120' track is also heavier and accommodates brush seal, should it be needed. Both systems use the same sealed precision bearings to provide smooth effortless motion.

Kits Available

SR80-20/1
Track Length: 2000mm,
Single Panel

SR80-30/1
Track Length: 3000mm,
Single Panel

SR120-20/1
Track Length: 2000mm,
Single Panel

SR120-30/1
Track Length: 3000mm,
Single Panel

SR120-1PK
120kg Pack of Fittings only

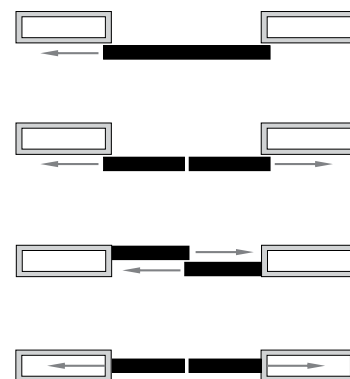

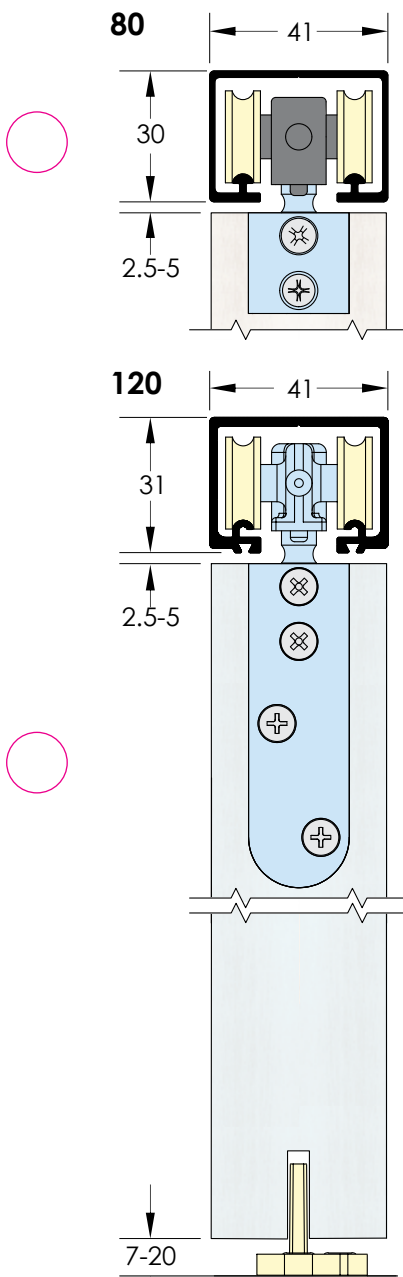

Zero Clearance 80 and 120

Max Panel Weight	Max Panel Width	Max Panel Height	Min Panel Thickness	Height Adjustment	Horizontal Adjustment
80/120kg	2000mm	3000mm	28mm	± 2.0mm	-

Application

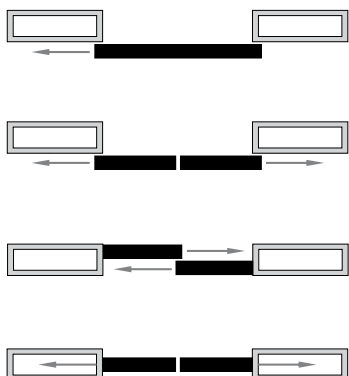

Zero Clearance 80 and 120 are the definitive straight sliding systems. With panels appearing to float just below the track, there are no large gaps to hide and no need to recess the hardware. Zero Clearance uses an ingenious sliding rail mechanism rebated into the top of the panel to achieve the ultra low clearances between panel and track. To adjust the height, simply loosen the end cap and slide the inner sleeve out to gain access to the height adjustment mechanism. When assembled, no further adjustment is possible, simple and 100% effective.

Kits Available

ZC80-20/1
Track Length: 2000mm,
Single Panel

ZC80-30/1
Track Length: 3000mm,
Single Panel

ZC120-20/1
Track Length: 2000mm,
Single Panel

ZC120-30/1
Track Length: 3000mm,
Single Panel

ZC120-1PK
120kg Pack of Fittings only

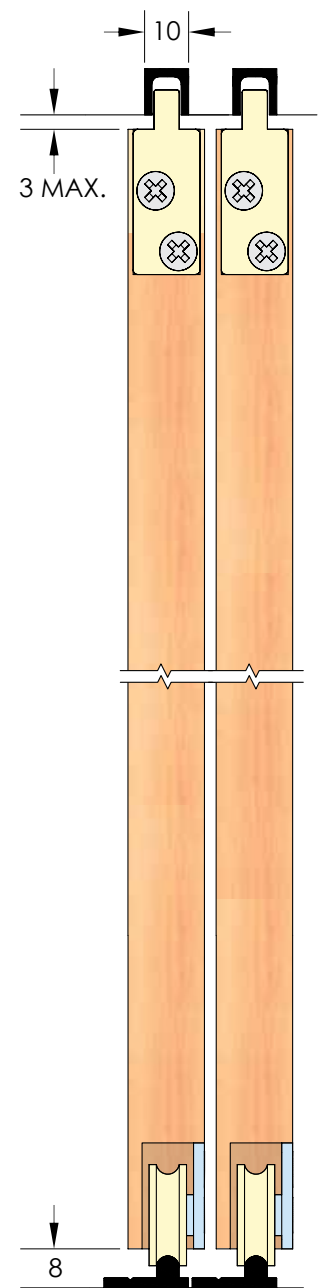

Timberoll 25

Max Panel Weight	Max Panel Width	Max Panel Height	Min Panel Thickness	Height Adjustment	Horizontal Adjustment
25kg	900mm	2400mm	16mm	-	-

Application

Timberoll 25 is designed with cabinets in mind, using only the best materials. The body is cast stainless steel to which is riveted a wheel fitted with a precision bearing. Endurance testing suggests anything else is a compromise. The sealed bearing ensures extended life with contamination being a common cause of failure for bottom rolling systems.



Kits Available

TR25-12/2
Opening Width: 1200mm, 2 Panels

TR25-15/2
Opening Width: 1500mm, 2 Panels

TR25-18/2
Opening Width: 1800mm, 2 Panels

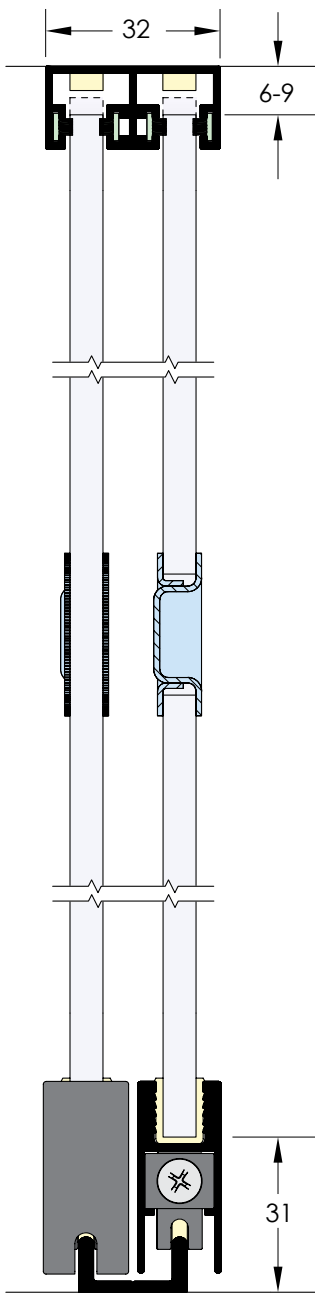

Glassroll 30

Max Panel Weight

30kg

Max Panel Area

2.5m² / 3.8m²

Max Panel Height

—

Min Panel Thickness

6mm

Height Adjustment

± 2mm

Horizontal Adjustment

—



Application

Glassroll 30 is ideal for cabinets and display units. Glassroll 30 is one of the easiest cabinet systems to install and adjust. Unlike many others there is no need to remove and replace the panel numerous times to find the optimum height. Adjustment is possible with the glass panel in place, making installation accurate, quick and easy. For security, Glassroll comes with its own dedicated lock as an optional extra, which fits to the glazing rail.

Kits Available

GR30-12/2

Opening Width: 1200mm, 2 Panels

GR30-15/2

Opening Width: 1500mm, 2 Panels

GR30-18/2

Opening Width: 1800mm, 2 Panels

Kit Specifier

	Capacity Kg	Top Hung Straight Sliding	Top Hung Folding	Bottom Rolling Straight Sliding	Face Fix Top of opening below ceiling	Soffit Fix Top of opening below ceiling	Soffit Fix Top of opening level with ceiling	multiple line option	Cabinet Timber	Cabinet Glass
Biffod 16	16kg		•			•				
Multifold 30	30kg		•			•				
Sprinline 30	30kg	•			•					
Wardrobe Single 50	50kg	•			•					
Wardrobe Double 50	50kg	•				•				
Single Run 60	60kg	•			•		•			
Single Run 80	80kg	•				•	•			
Single Run 120	120kg	•				•	•			
Zero Clearance 80	80kg	•				•	•			
Zero Clearance 120	120kg	•				•	•			
Timberoll 25	25kg			•					•	
Glassroll 30	30kg			•						•



Accessories

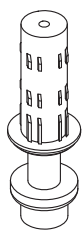

No. 801

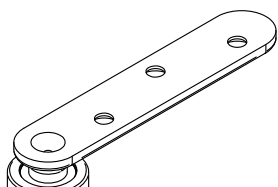

No. 106SSMF

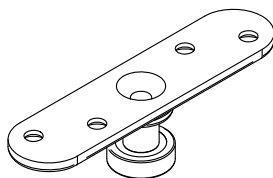

No. 106E/94

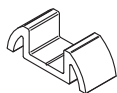

No. 92

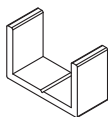

No. 96W

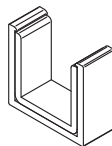

No. 94PPA

Alternative spring loaded guide & channel
Multifold 30
Single Run 60

Alternative guide & channel
Multifold 30

Alternative guide & channel with poly.
Single Run 80/120
Zero Clearance 80/120

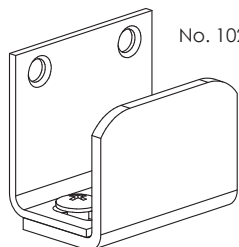

No. 102WA

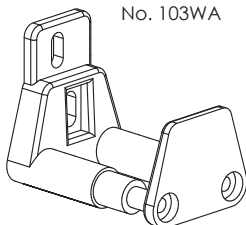

No. 103WA

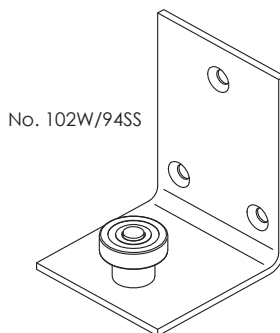

No. 102W/94SS

Alternative saw cut guide
Sprintline 30
Twinwheel 45
Single Run 60

Alternative guide
Sprintline 30
Twinwheel 45
Single Run 60

Alternative guide
Zero Clearance 80/120

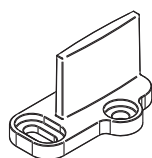

No. 101N

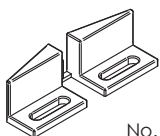

No. C155LS

Alternative saw cut guide
Sprintline 30, Twinwheel 45
Wardrobe, Single Run 60
Single Run 80/120
Zero Clearance 80/120

Optional cavity guide
Single Run 60

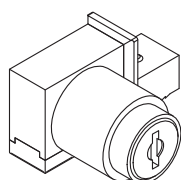

No. 527A

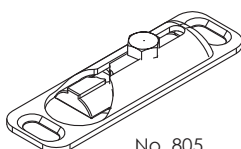

No. 805

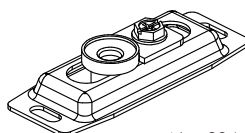

No. 804

Optional lock
Glassroll 30/50

Alternative floor bracket
Multifold 30

Alternative floor bracket
Bifold 16

Call Brio for further details on Locks and Pulls



Brio®

Brio RMD (UK) Ltd
Unit 30 Gateway West, Kingfisher Boulevard, Newburn Riverside,
Newcastle Upon Tyne, NE15 8NZ, United Kingdom
Phone +44 (0) 191 2291224 Fax +44 (0) 191 2677891
www.briouk.com

email: sales@briouk.com

Brio RMD (UK) Limited trading as Brio, is a subsidiary of the Brio Group, a division of RMD Industries

Brio USA Inc.
85 Mushroom Blvd
Rochester, NY 14623-3201
Toll Free +1 855 586 6251 Phone +1 585 319 5599 Fax +1 585 319 5741
www.briouisa.com

email: sales@briouisa.com

Brio USA Inc. trading as Brio, is a subsidiary of the Brio Group, a division of RMD Industries

Brio NZ
26C Neil Park Drive
East Tamaki, Auckland
Phone +64 9 277 0040 Fax +64 9 277 0140
www.brionz.com

email: sales@brionz.com

Brio NZ trading as Brio, is a subsidiary of the Brio Group, a division of RMD Industries

Brio – Australia
PO Box 140, Regents Park NSW 2143
C5 - C7, Regents Park Estate, 391 Park Road,
Regents Park, NSW 2143, Australia.
Phone +61 2 8718 6718 Fax +61 2 8718 6719

www.brio.com.au

email: sales@brio.com.au

Brio Group Brio Group, a division of RMD Industries Pty Ltd ABN 31 004 313 937

Brio is a registered trademark of RMD Industries Pty Ltd